



# ELMO

V.le Certosa 8/B - 27100 Pavia Italy  
 Tel. + 39 382 529564 - 422372  
 Fax. + 39 382 527041  
 E-Mail: info@elmoitaly.com

### SUBMERSIBLE MOTORS FOR HYDRAULIC LIFTS

### MOTORS SIZE 1 - HORIZONTAL EXECUTION

Shaft / hole Ø32 mm. Special Flange Ø95 mm.

**50 Hz**  
 T4T2P24-T660N8Y  
 1709-20

MOTORI TRIFASI THREE PHASE MOTORS DREIPHASEENMOTOREN MOTEURS TRIPHASES

IN ANY MOMENT AND WITHOUT NOTICE ELMO CAN CHANGE MANUFACTURING PROCESS, PERFORMANCE FEATURES.

LA ELMO S.r.l. SI RISERVA IL DIRITTO DI APPORTARE QUALSIASI VARIAZIONE SENZA ALCUN PREAVVISO.

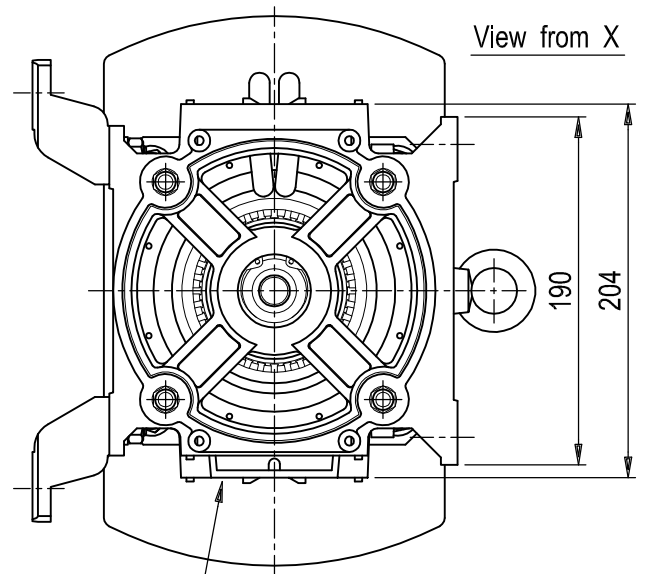
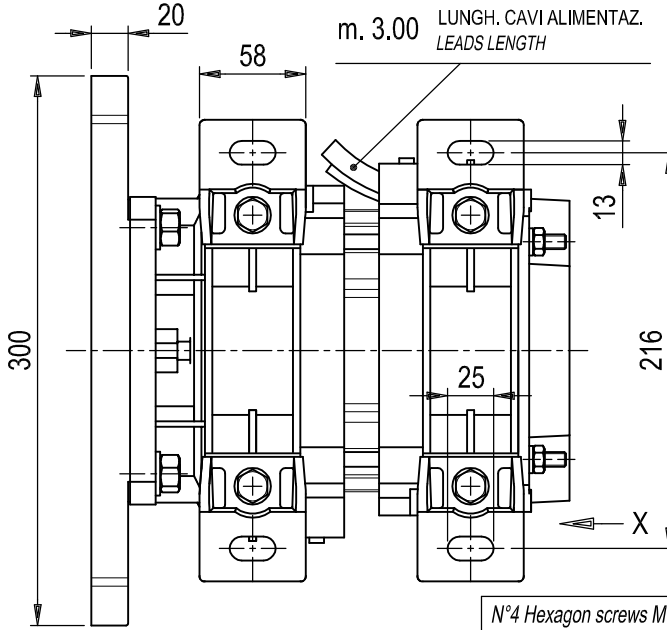

N°4 Hexagon screws M12x40 - 8.8 DIN 933 M10  
 N°4 Selflocking hex nuts M12 - 8 DIN 6923  
 N°4 Plain washers 13x24 DIN 125 A

Su questo lato: targhetta motore 50/60 Hz 380/440V  
 On this side motor rating plate 50/60 Hz 380/440V

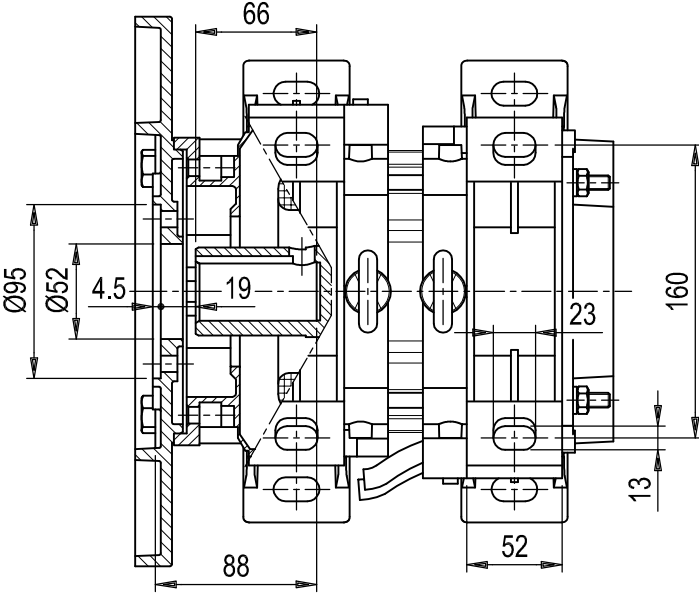
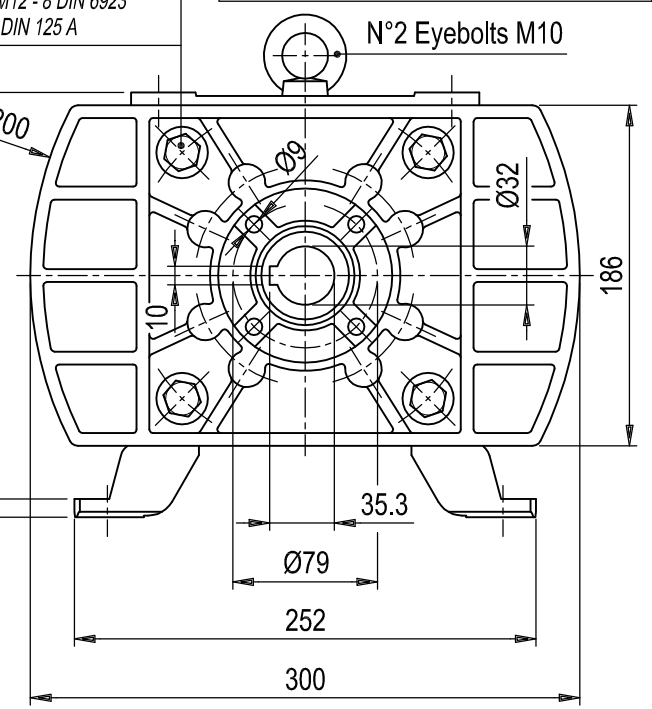
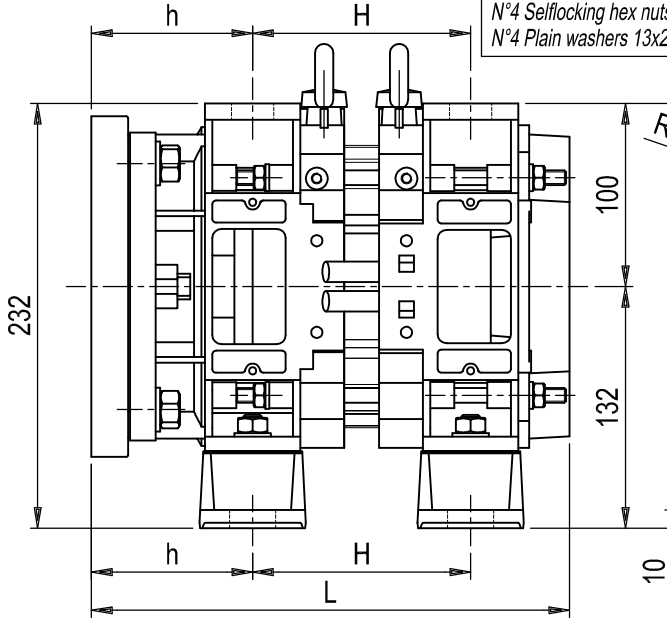

### MOTORS WITHOUT FLYWHEEL

TIPO - TYPE	GRANDEZZA - ACCOPPIAM. / SIZE - SUITABLE TO	POLARITÀ - POLES	SERIE - INTERNAL SERIES	POTENZA A 50 Hz Δ 380 V / NOMINAL OUTPUT AT 50 Hz Δ 380 V	TRIFASE - THREE PHASE	TENSIONE (Λ) / VOLTAGE (Λ)	50 Hz - CYCLES AT 50 Hz	ATTACCHI - FEET	TERMINALI - LEAD TERMINAL	DIMENSIONI / DIMENSION			POTENZA A 60 Hz Δ 440 V / NOMINAL OUTPUT AT 60 Hz Δ 440 V				
T	4	T	2	P	24	-	T	6	6	0	N	8	Y	L	h	H	kW
														406	88	264	2.6